

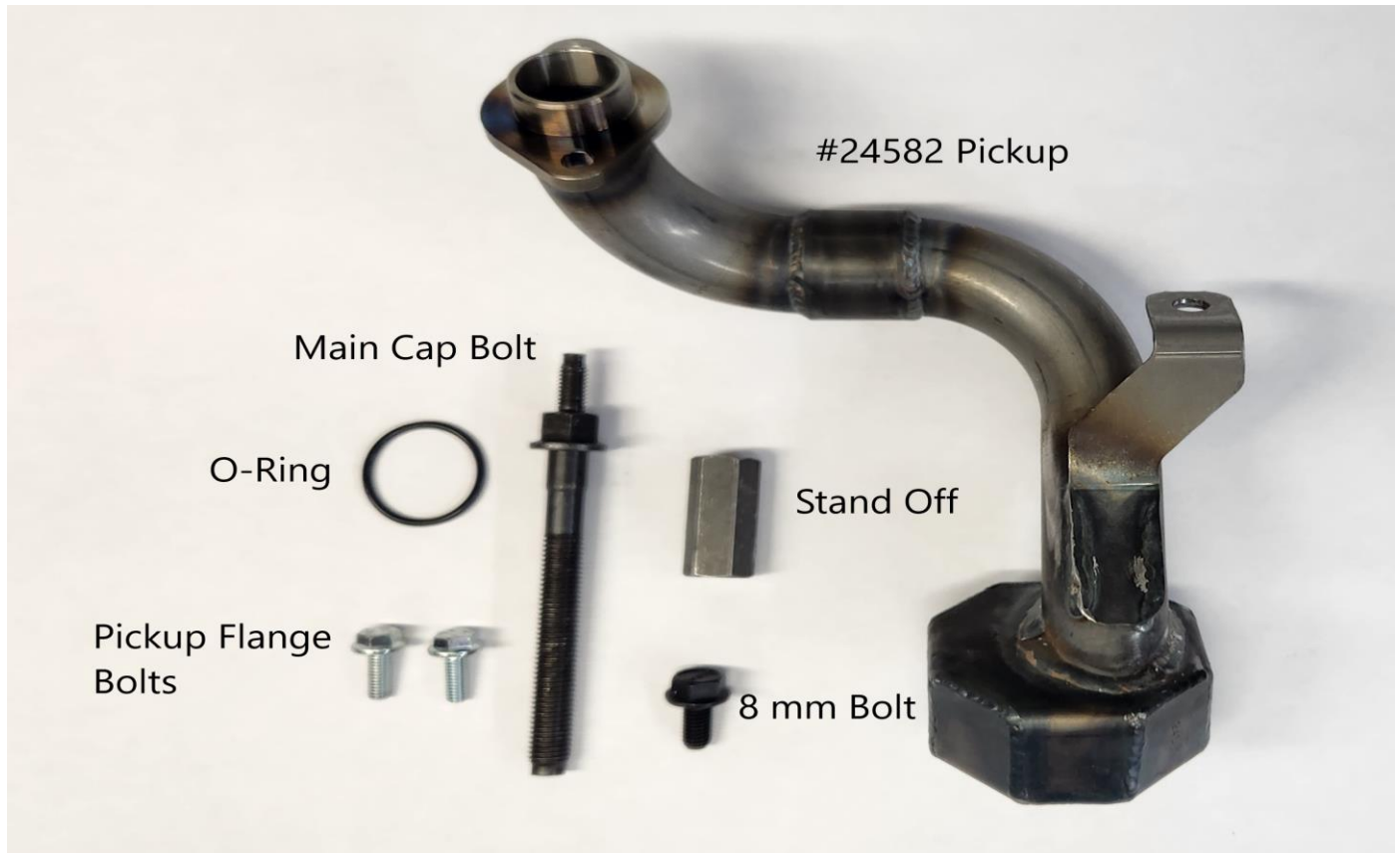

**FORD COYOTE FRONT SUMP PICK-UP
INSTALLATION INSTRUCTIONS
P/N 24582**

Parts List:



*****FORD FACTORY HARDWARE IS TORQUE TO YIELD AND SHOULD NEVER BE REUSED. ALL TORQUE VALUES LISTED IN THE INSTRUCTIONS BELOW ARE ACHIEVED USING MOTOR OIL ON THE THREADS PER FORD FACTORY INSTRUCTIONS.**

****Please note, this pickup only fits with Moroso oil pan P/N 20573. In order to install this pickup you must have the proper gasket / tray, Moroso P/N: 22936, or Ford P/N: BR3Z-6710 A. Modifications to the tray are required to use this pickup and are illustrated in the instructions. Additionally, if you have the old style 20573 pan, the slosh tray in the pan will have to be notched for clearance. See last page for a template.**

**For Technical Assistance, Call Moroso's Tech Line at
(203) 458-0542, 458-0546 8:30am – 5:00pm Eastern Time**

MOROSO PERFORMANCE PRODUCTS, INC
80 CARTER DR • GUILFORD, CT 06437-2116
Phone: (203) 453-6571 • Fax: (203) 453-6906

Completed installation

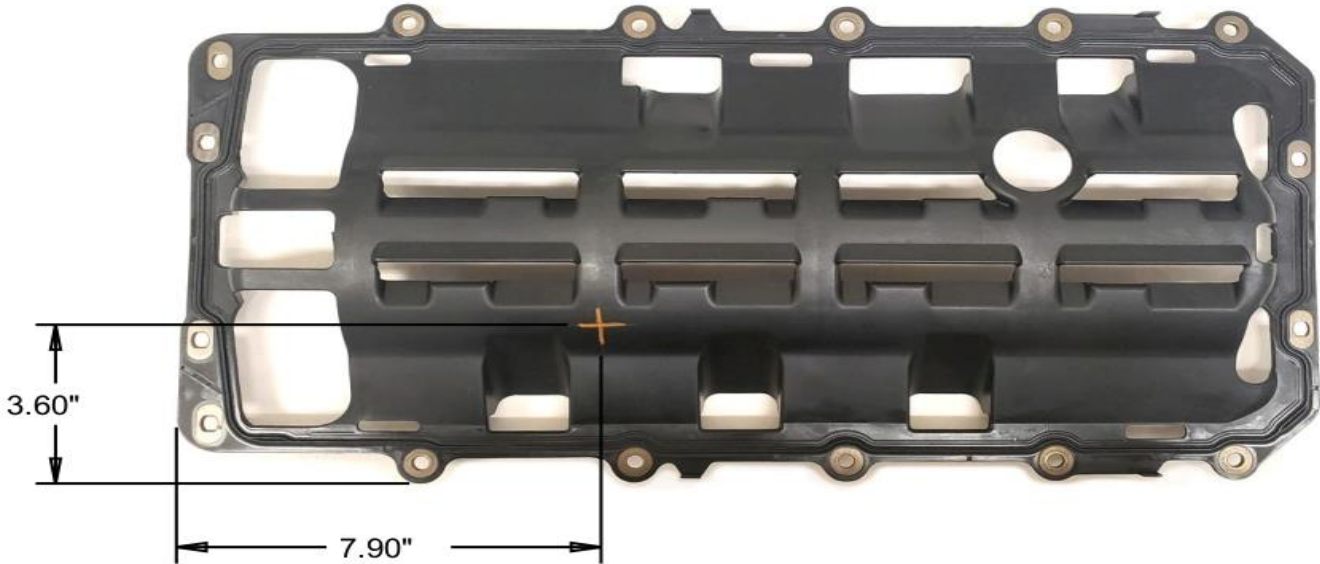
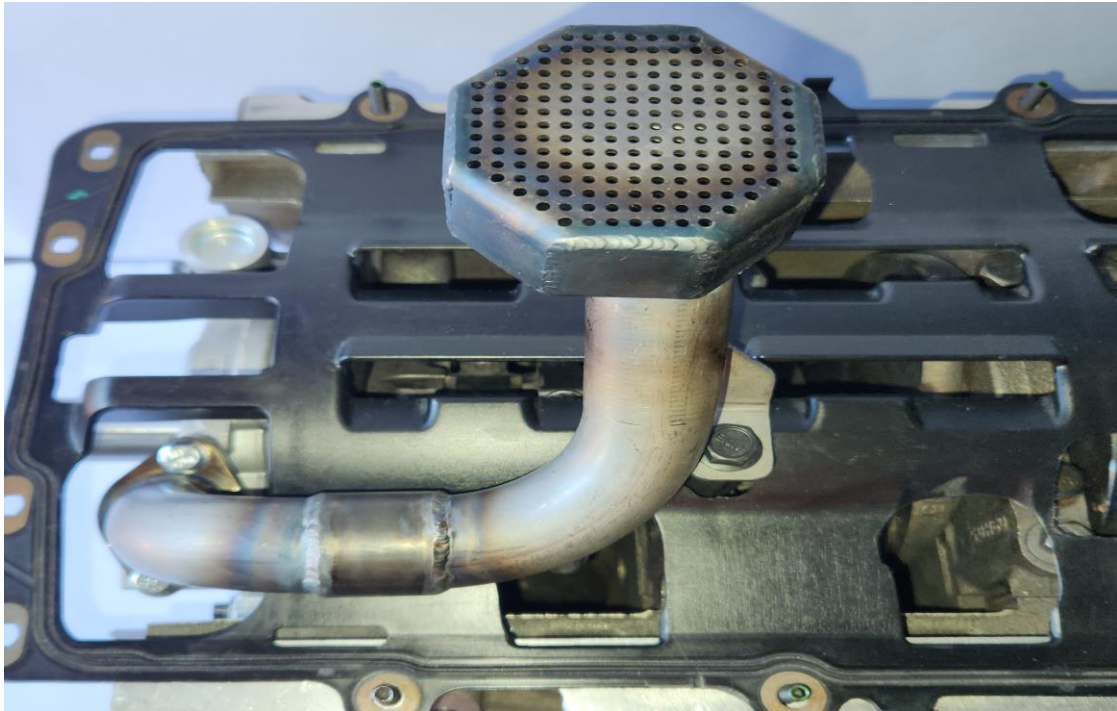

Step 1: Scribe the tray in the location shown above.

**For Technical Assistance, Call Moroso's Tech Line at
(203) 458-0542, 458-0546 8:30am – 5:00pm Eastern Time**

MOROSO PERFORMANCE PRODUCTS, INC
80 CARTER DR • GUILFORD, CT 06437-2116
Phone: (203) 453-6571 • Fax: (203) 453-6906

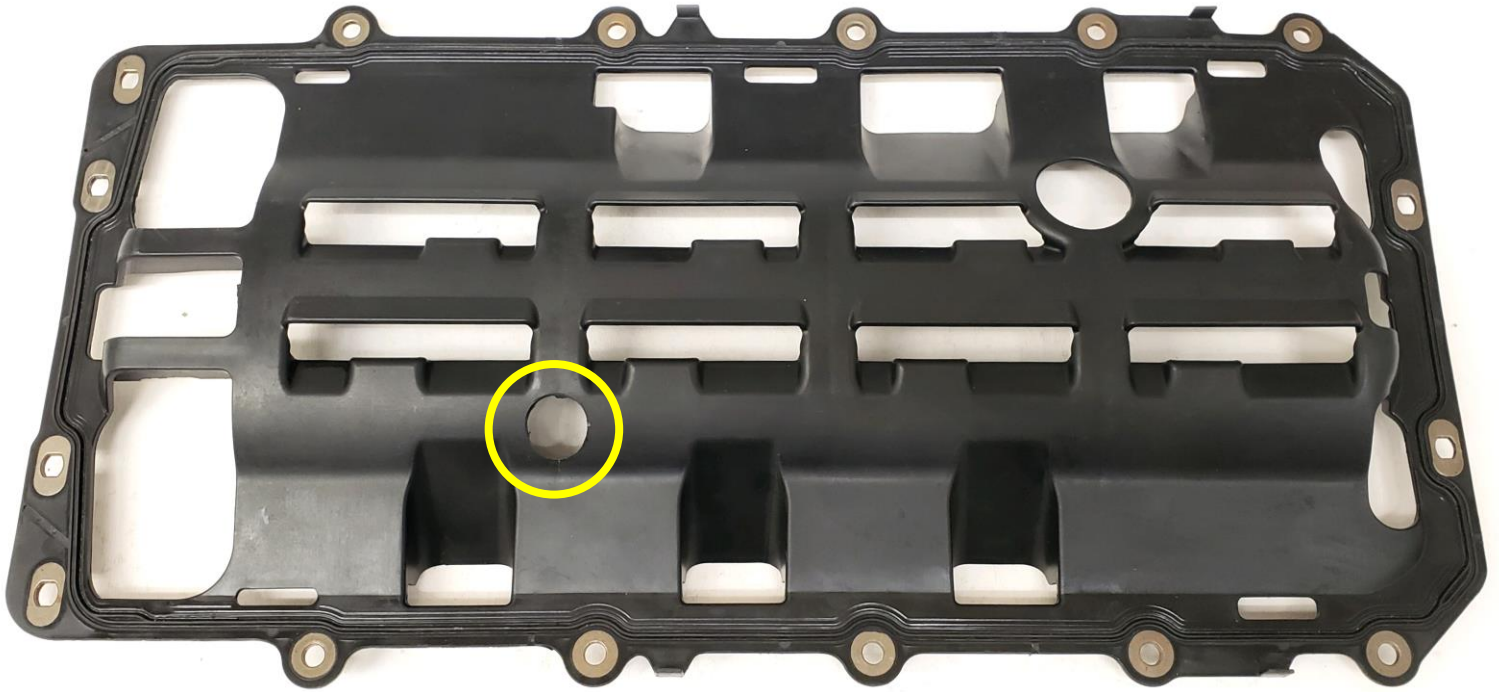

Step 2: Drill a hole in the scribed location using a 7/8" hole saw.

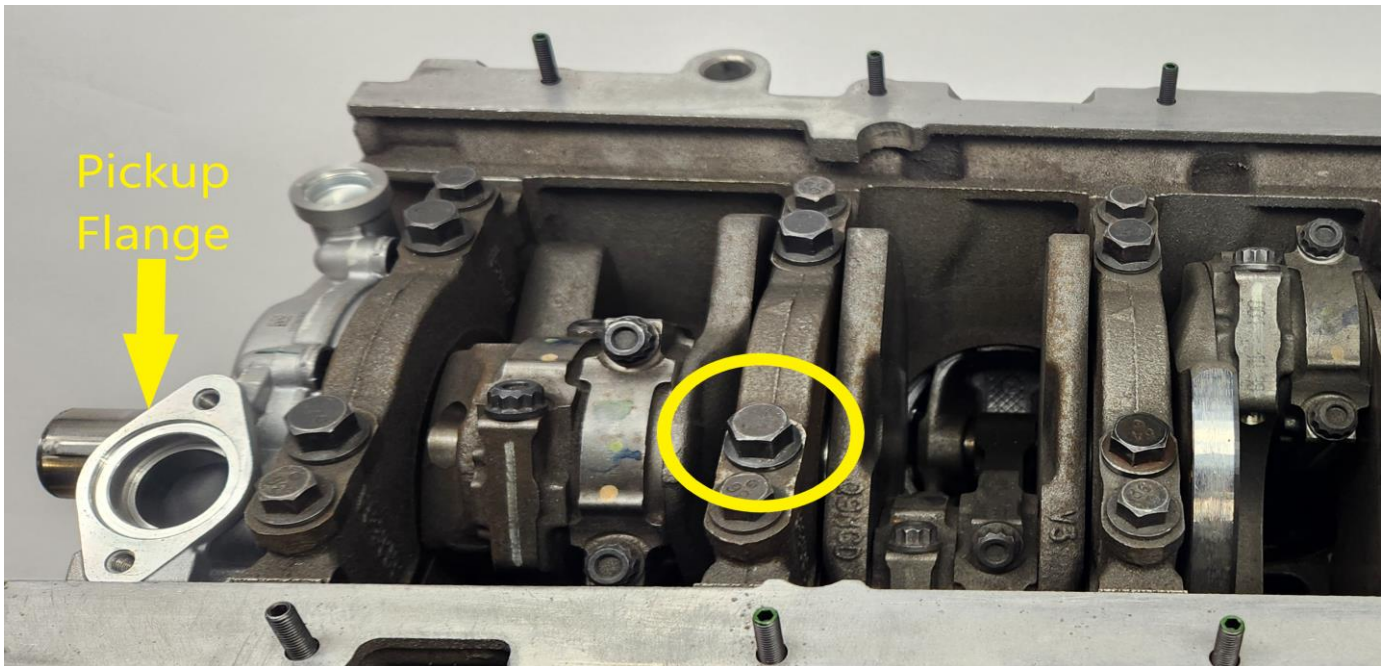

Step 3: Remove the factory main cap bolt

**For Technical Assistance, Call Moroso's Tech Line at
(203) 458-0542, 458-0546 8:30am – 5:00pm Eastern Time**

MOROSO PERFORMANCE PRODUCTS, INC
80 CARTER DR • GUILFORD, CT 06437-2116
Phone: (203) 453-6571 • Fax: (203) 453-6906

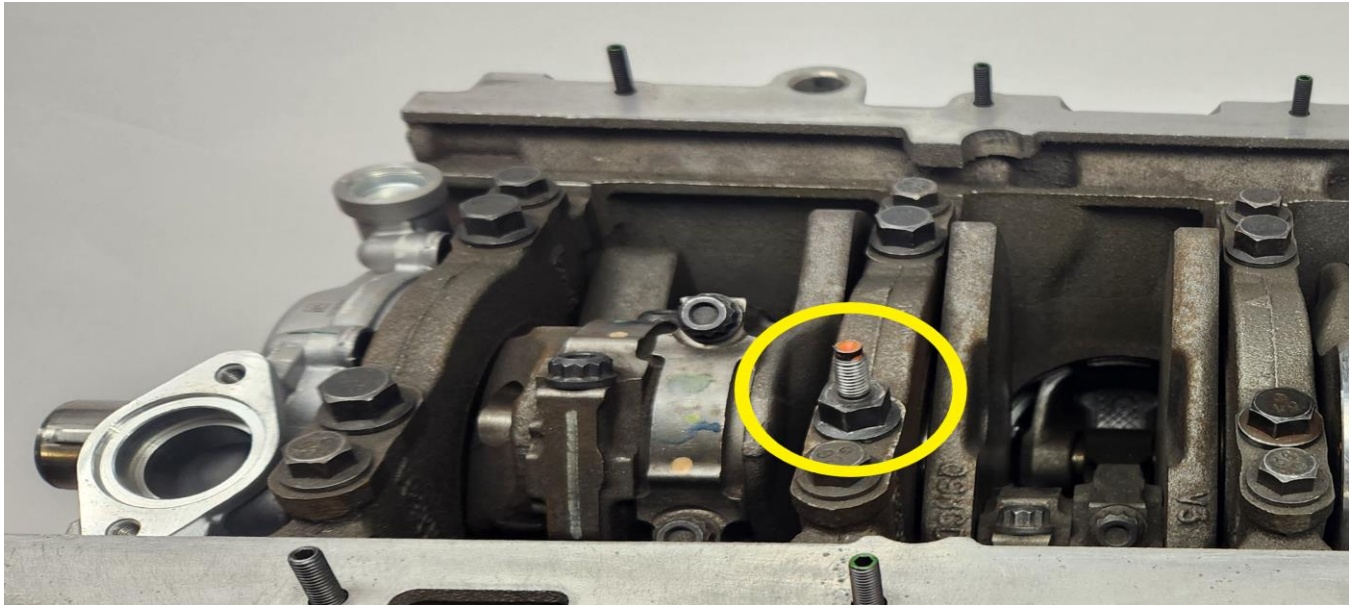

Step 4: Install the provided main cap bolt.

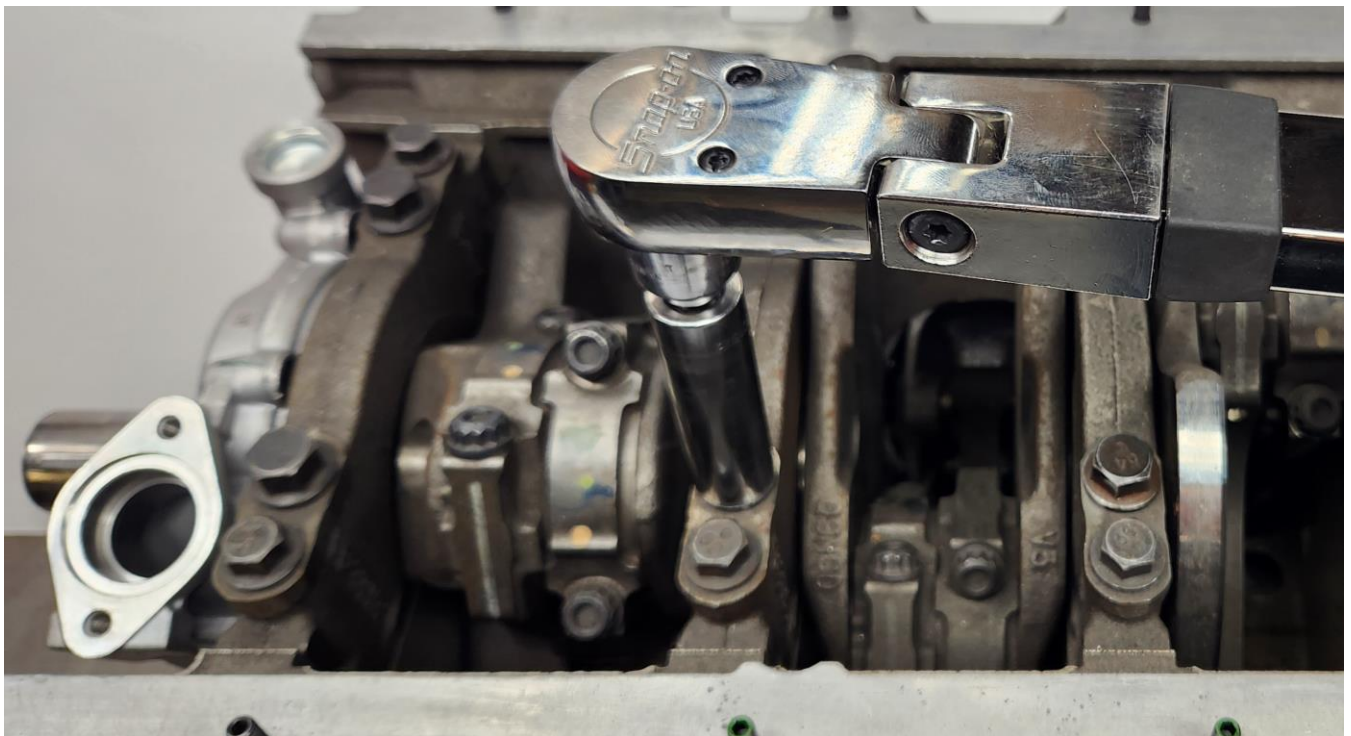

**Step 5: Torque the main cap bolt to 65 N-m for the first pass and 90° for the final pass
This fastener must be the Moroso supplied bolt for final installation**

**For Technical Assistance, Call Moroso's Tech Line at
 (203) 458-0542, 458-0546 8:30am – 5:00pm Eastern Time**

MOROSO PERFORMANCE PRODUCTS, INC
 80 CARTER DR • GUILFORD, CT 06437-2116
 Phone: (203) 453-6571 • Fax: (203) 453-6906

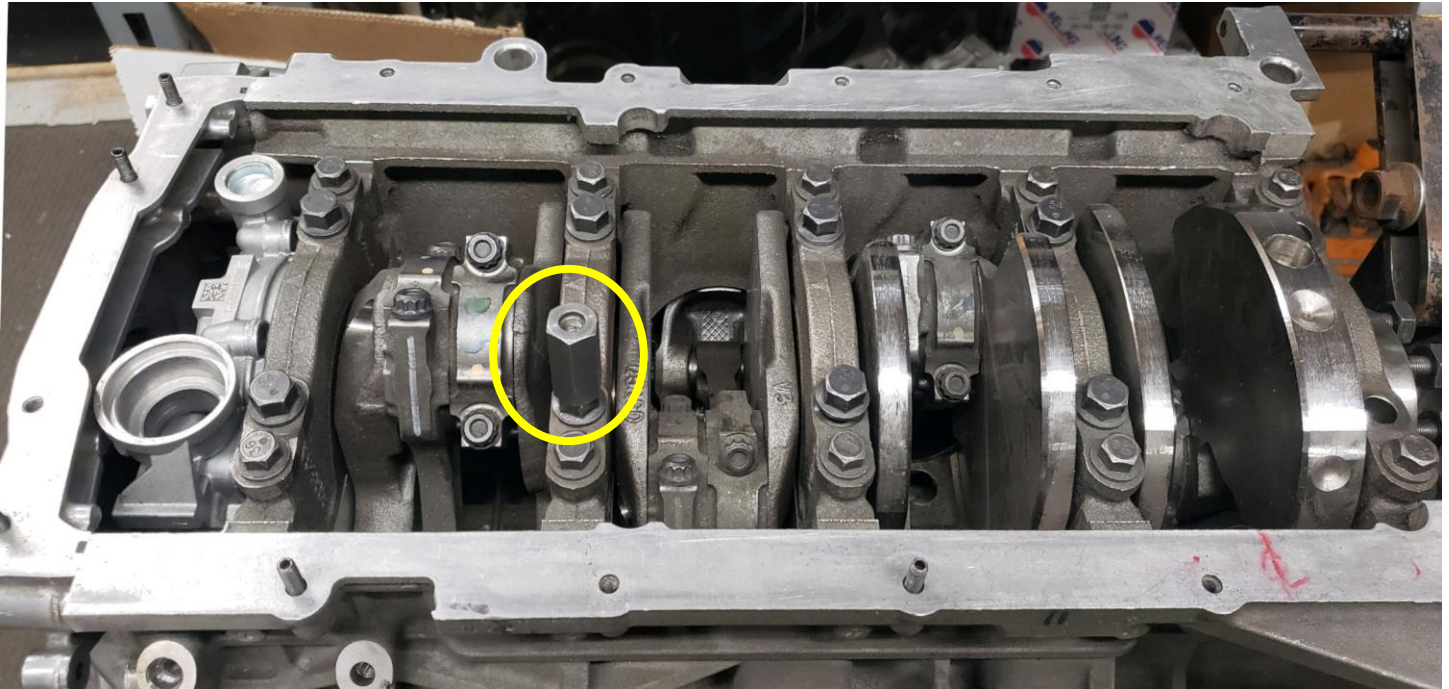

Step 6: Install the standoff.



Step 7: Torque the standoff to 25 N-m

**For Technical Assistance, Call Moroso's Tech Line at
(203) 458-0542, 458-0546 8:30am – 5:00pm Eastern Time**

MOROSO PERFORMANCE PRODUCTS, INC
80 CARTER DR • GUILFORD, CT 06437-2116
Phone: (203) 453-6571 • Fax: (203) 453-6906

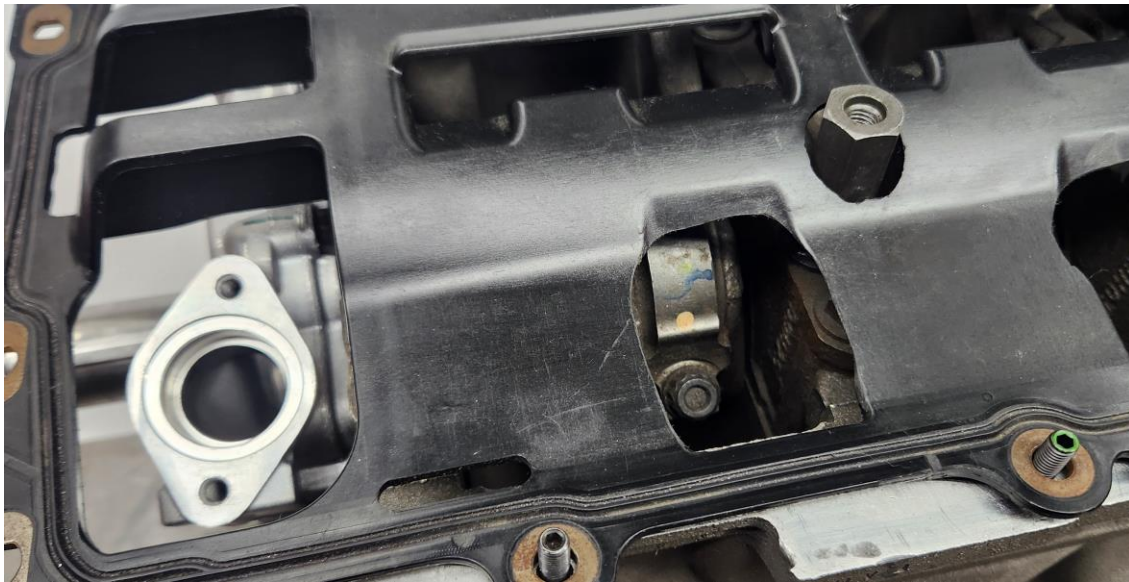

STEP 8: Install the tray and confirm clearance around the standoff hole is correct (See STEP 2)



Step 9: Install the provided O-ring on the pickup and lubricate with engine oil.

**For Technical Assistance, Call Moroso's Tech Line at
(203) 458-0542, 458-0546 8:30am – 5:00pm Eastern Time**

MOROSO PERFORMANCE PRODUCTS, INC
80 CARTER DR • GUILFORD, CT 06437-2116
Phone: (203) 453-6571 • Fax: (203) 453-6906



Step 10: Install the pickup into the pump, (you must use Moroso supplied bolts) and torque to 16 N-m.

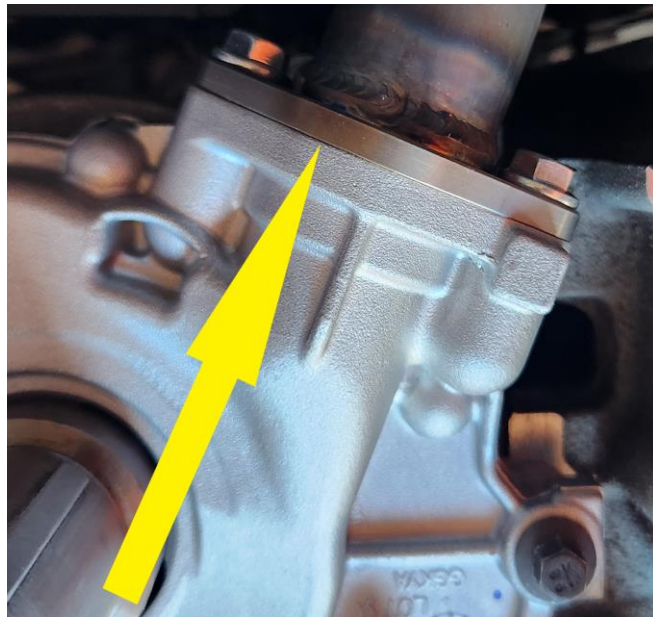

Step 11: Note: pickup must be fully seated in the oil pump.

**For Technical Assistance, Call Moroso's Tech Line at
(203) 458-0542, 458-0546 8:30am – 5:00pm Eastern Time**

MOROSO PERFORMANCE PRODUCTS, INC
80 CARTER DR • GUILFORD, CT 06437-2116
Phone: (203) 453-6571 • Fax: (203) 453-6906

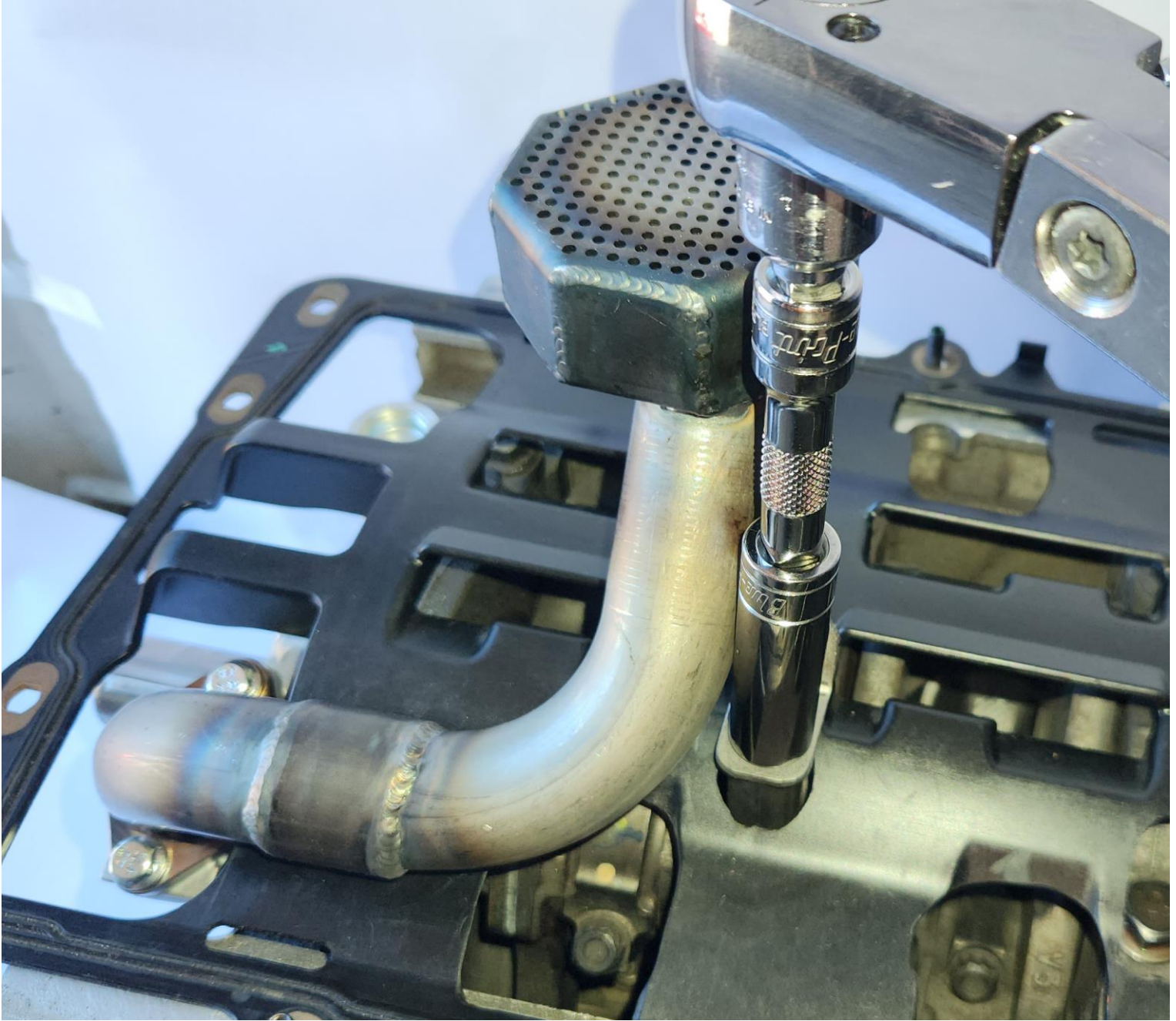

Step 12: Complete installation by torquing the 8mm flange head screw to 25 N-m

**For Technical Assistance, Call Moroso's Tech Line at
(203) 458-0542, 458-0546 8:30am – 5:00pm Eastern Time**

MOROSO PERFORMANCE PRODUCTS, INC
80 CARTER DR • GUILFORD, CT 06437-2116
Phone: (203) 453-6571 • Fax: (203) 453-6906

IMPORTANT: If you have an old style Moroso oil pan tray, you must notch the tray using the template below. Failure to do so will cause interference between the pickup tube and the tray, not allowing the pan to seal properly.

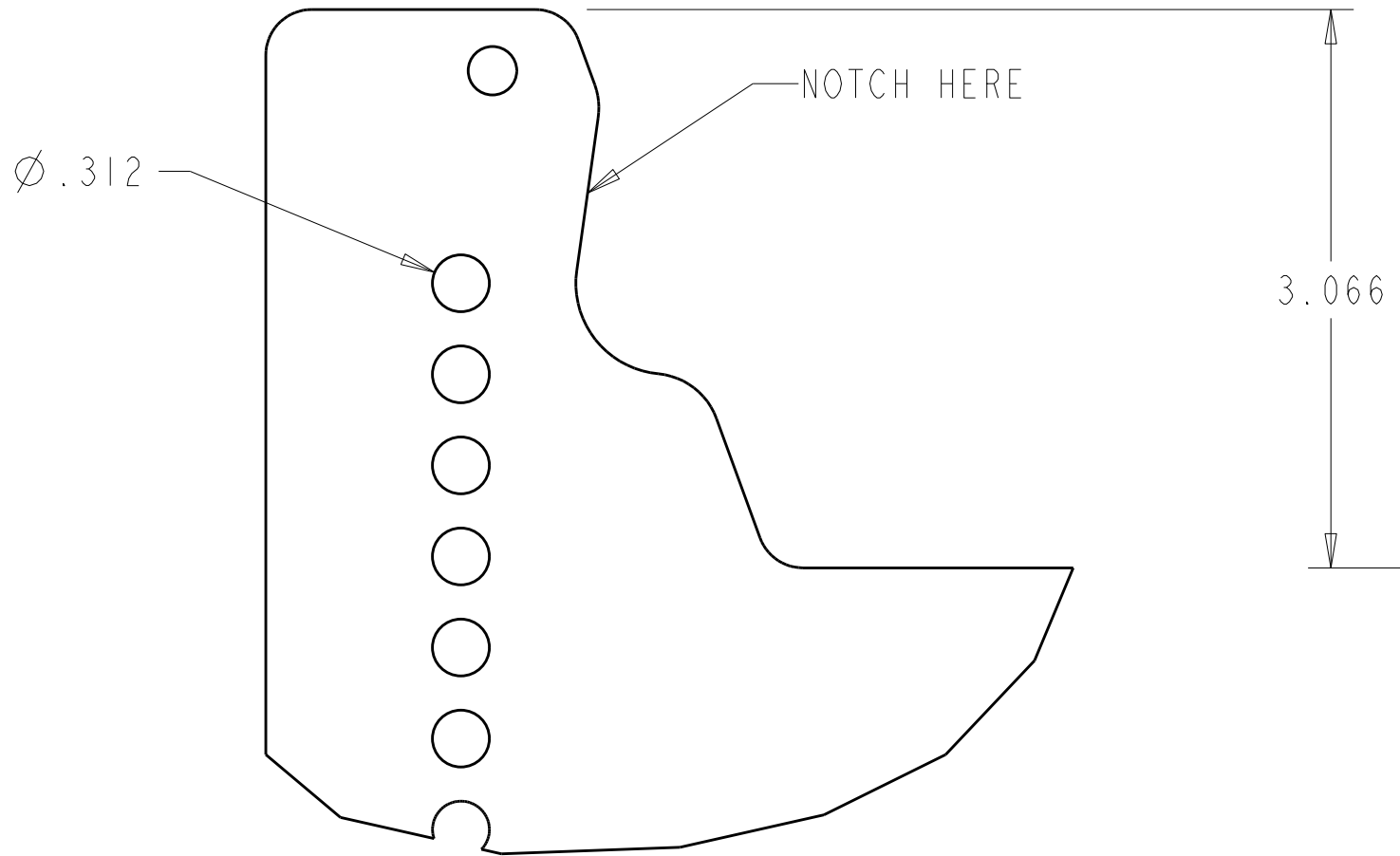

**PRINTER MUST BE SET TO PRINT ACTUAL SIZE FOR
TEMPLER TO BE CORRECT**